



## DL2 DS Link Sony TTL Converter Ikelite ST1 Hotshoe and B1A Bulkhead Kit

Product # 46045

### Included in the Box

- DL2 DS Link Sony TTL Converter # 46043
- ST1 Sony TTL Hotshoe # 46041

### Important Notices

- » **The DL2 DS Link is not compatible with other manufacturers' strobes.**
- » **Use of two strobes requires a dual sync cord. Two strobes cannot be controlled by individual converters even if the housing is equipped with two bulkheads.**

## Installation and Use

### Installing the B1A Bulkhead

1. Carefully remove the accessory port plug using an 11/16" wrench.
2. Remove the nut from the end of the bulkhead with the cord coming out. Check that the sealing surface and o-ring on the bulkhead are clean. No lubricant is necessary.
3. Thread the bulkhead into the 1/2-20 hole in the top of the housing being careful not to cross-thread.
4. Use an 11/16" wrench to carefully tighten down the bulkhead just until it touches the case. Do not over-tighten.
5. Re-attach the nut on the inside of the case. Tighten snug with a 5/8" wrench.

### Installing the ST1 TTL Hotshoe

1. Depress the tab on the manual hotshoe connector and gently pull connector ends apart to remove the housing's manual hotshoe.

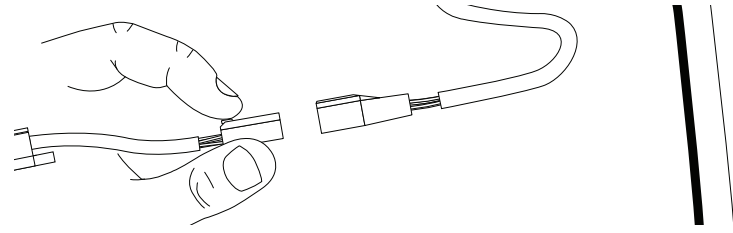

2. Align TTL hotshoe and bulkhead connector ends and push together until tab clicks into place.
  3. Push hotshoe forward into camera's hotshoe mount. Make sure that the hotshoe is all the way forward to ensure proper connection.
- » **The ST1 TTL Hotshoe is only intended for use with compatible Ikelite brand housings.**

### Testing the Housing

1. Assemble the housing without a camera installed. Ensure that a waterproof bulkhead cap is in place on the bulkhead.
2. Submerge the housing in fresh water for several minutes.
3. Remove the housing from water and dry the outside of the housing with a clean, lint-free cloth.
4. Look through the back of the housing for signs that water has entered the housing. Signs include fogging or water droplets.
5. We recommend making at least one dive without a camera installed to ensure waterproof operation.

### Attaching the Converter

1. Remove connector protectors and bulkhead caps from each connection.

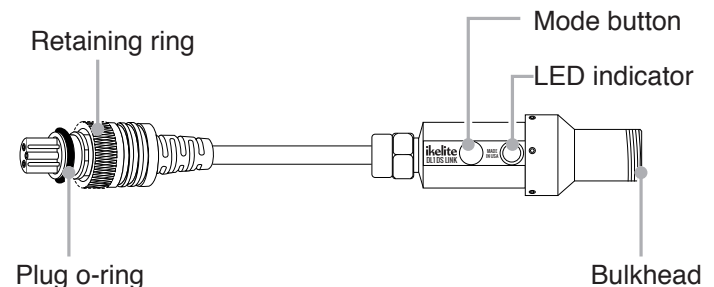

2. Apply a very thin, even layer of lubricant on all threads, sealing surfaces, and the exposed portion of the plug o-ring. Do not allow lubricant to get into the pins and receptacles of the plug or bulkheads.
3. Align plug and insert into the housing bulkhead. Each male pin mates with a female receptacle. Failing to line up the contacts properly before tightening may result in damage to the converter plug and/or housing bulkhead.

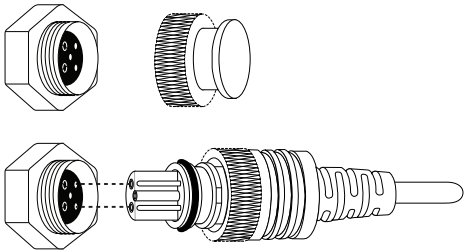

4. Hand-tighten the retaining ring.
5. Attach a compatible sync cord to the converter using the same method. Hold the converter while tightening the sync cord retaining ring.
6. Attach a compatible strobe(s) to the sync cord.

## Setting Your Camera

Refer to your camera and housing instruction manuals for recommendations on flash settings for external strobes. In general:

- **Flash mode** must be set to Fill flash or Rear Curtain Sync. Do not use a red eye reduction mode.
- **DRO/Auto HDR** must be turned off (default).

If you are having trouble getting your strobe(s) to fire or expose properly we recommend restoring your camera to factory default settings and making sure the hotshoe is pushed all of the way forward.

## Shooting with TTL Strobe Exposure

1. Turn strobe on. When turned on the DL2 DS Link will be in TTL mode. The LED indicator glows blue in TTL mode.
  2. Set the strobe to TTL.
  3. Exposure compensation may be added or subtracted through the camera's menus. Refer to your camera instruction manual for more information.
- » **It is only possible to toggle between TTL (blue LED) and Manual (red LED) when a camera is connected.**
- » **An incorrectly mounted hotshoe may prevent toggling between TTL and Manual.**

## Shooting with Manual Strobe Exposure

1. Push the mode button on the side of the converter. The LED indicator light will change from blue to red.
2. Set the strobe to full or a fractional power setting.
3. Adjust strobe power settings as necessary for each photo.
4. To revert to TTL operation push the mode button and set your strobe to TTL.

## Maintenance and Storage

### Post-Dive

1. Submerge the fully assembled system in clean, fresh water after each use. Press the mode button several times while submerged.
2. Remove the system from the rinse tank and flush with running fresh water.
3. Dry the system with a clean, lint-free cloth.
4. Separate the components and lubricate the threads and o-ring(s) every 2-3 days during continuous use.

### Travel and Storage

1. Separate the converter from the sync cord and housing.
2. Wipe off the threads of each bulkhead and retaining ring using a clean, lint-free cloth.
3. Lightly lubricate all o-rings, threads, and sealing surfaces.
4. Attach the connector protector and waterproof bulkhead cap to converter ends.

## Limited Warranty

This Ikelite product is warranted against any manufacturing defects for a period of one (1) year from the original date of purchase. To obtain warranty service, the product must be returned to Ikelite postage paid. Ikelite will, at its sole discretion, repair or replace such products, and will return to customer postage paid. All other claims of any nature are not covered. Except as mentioned above, no other warranty expressed or implied applies to this Ikelite product.

Ikelite Underwater Systems  
 50 W 33rd St  
 Indianapolis, IN 46208 USA  
 (317) 923-4523  
 ikelite@ikelite.com