



AF35 Strobe with Optical TTL

Product Numbers 4035 • 4035.1 • 4035.2

Product Registration

Please register your product at ikelite.com within 15 days of purchase. Our product registration database is the best way for us to get a hold of you in the event of a product update or recall.

About this Product

Thank you for your purchase of Ikelite equipment. Please read this instruction manual completely before attempting to operate or dive with this product. Please visit ikelite.com to register your product to receive information on any updates, notices, or recalls pertaining to your equipment.

The AF35's built-in sensor transmits data from the camera's flash to the AF35 strobe, varying the strobe's power automatically to replicate TTL exposure. The AF35 sensor is positioned to provide the most reliable strobe triggering possible without exposed cables which require maintenance and can tangle or break.

Included in the Box

- AF35 Strobe
- Diffuser
- Built-in Flex Arm, TTL Sensor, and Rubber Grip
- Tray
- 12-24 Mounting Hardware
- 1/4-20 Mounting Hardware
- Flash Deflector Kit
- Silicone Lubricant

Contents

- 1 Product Registration**
- 2 About this Product**
- 3 Included in the Box**
- 6 Getting to Know Your Strobe**
- 8 Setting Up Your Camera**
- 8 Setting Up Your Housing**
- 11 Assembling the Strobe**
- 12 Configuring the AutoFlash Sensor**
- 13 Manual Flash Exposure**
- 13 Using the Diffuser**
- 14 Positioning the Strobe**
- 15 Maintenance**
- 16 Troubleshooting**
- 17 Photo Tips**
- 26 Service and Repairs**
- 27 Limited Warranty**
- 28 Contact Us**

Getting to Know Your Strobe

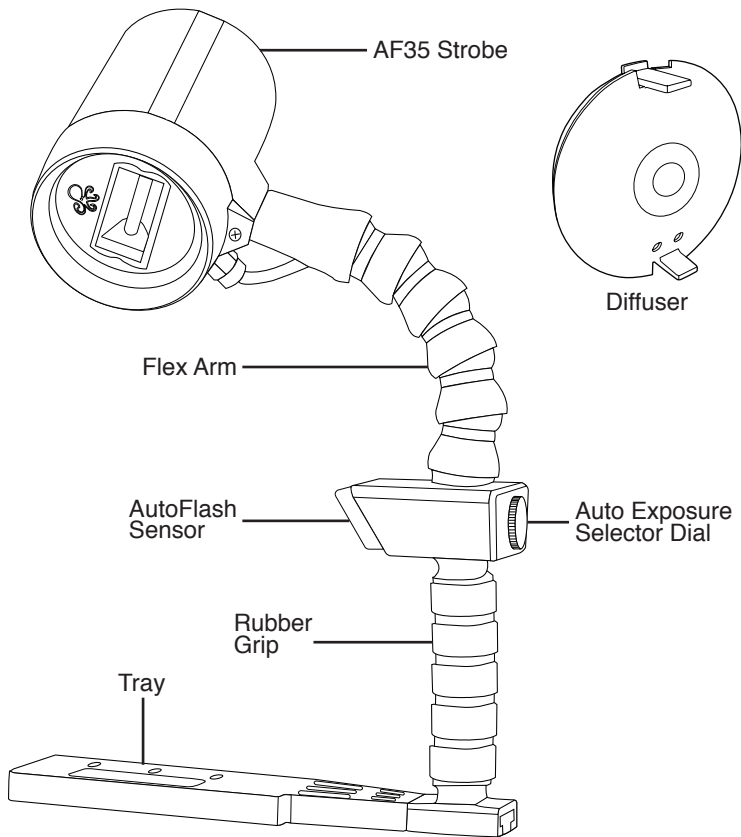

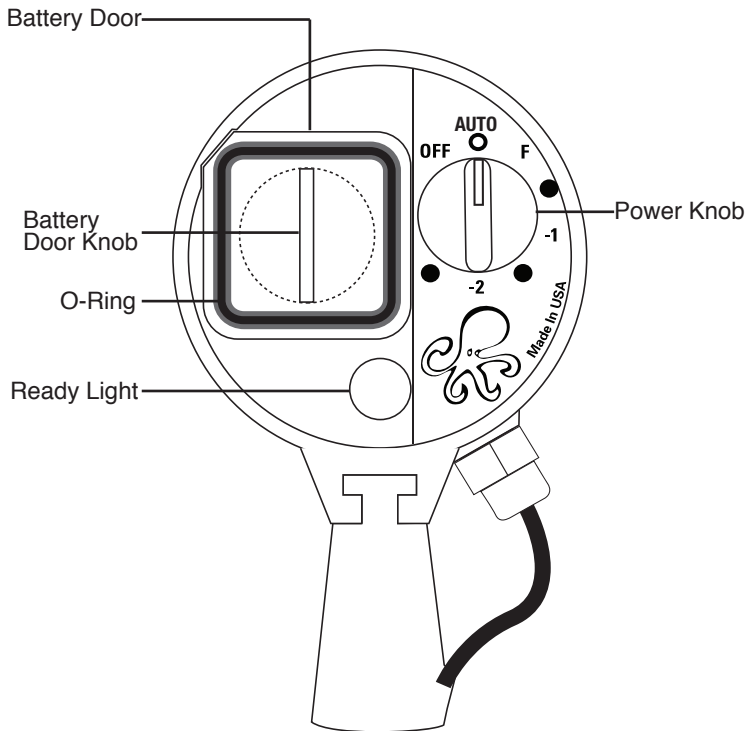

Setting Up Your Camera

- Start with new or fully charged batteries.
- Set your camera to its “flash on” or forced flash settings. Your camera’s flash must fire to trigger the AutoFlash Sensor.
- If possible, start with your camera in “A” Aperture Priority Mode with the smallest aperture (largest number) possible. If your camera does not have this mode, use “P” Program or Auto Mode.
- If possible, start with your camera set to ISO 200 or lower.
- Turn Macro Mode (typically a flower button) on if shooting small subjects.
- Point your camera at a close-by object and half-depress your camera’s shutter button without taking a picture. Look for a visual confirmation signal that the camera has achieved focus. Most cameras display a green box, light, or something similar. This signal also indicates that the camera has metered your subject to set the appropriate flash intensity. For the best results with both the built-in flash and the AF35 strobe, always wait for this confirmation before taking a photo.

Setting Up Your Housing

Attach the tray to the bottom of your housing. Choose the appropriate hardware based on the mounting style of your housing. Both 12-24 and 1/4-20 hardware are included with the tray.

Most Ikelite housings are marked with the thread size on the inside bottom of the housing. If your Ikelite housing is not marked, it is most likely 12-24 thread.

Most non-Ikelite housings have a single 1/4-20 thread.

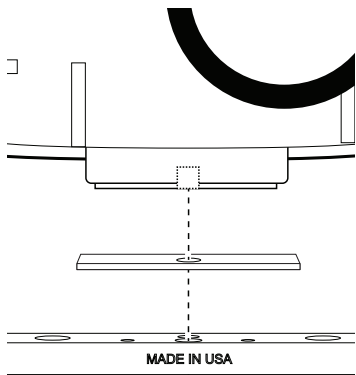

Non-Ikelite Housing

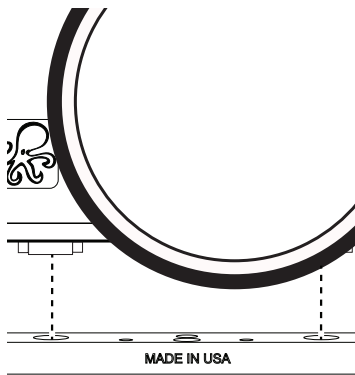

Ikelite Housing

Attach the AF35 Rubber Grip to the tray.

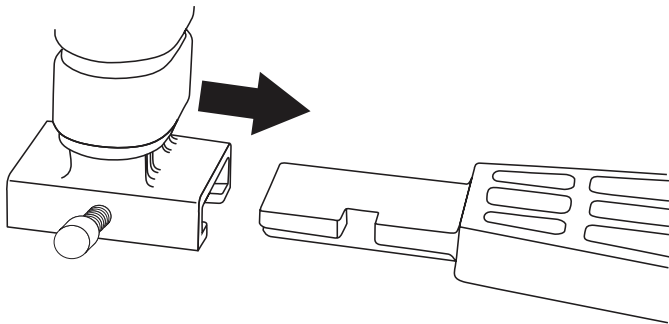

A flash deflector helps to reduce backscatter (the illumination of particles in the water resulting in the look of snow) and helps to trigger your strobe. We recommend always having a deflector in place for the most reliable operation.

If your housing came with a flash deflector, refer to your housing instruction manual for information on attaching it to your housing.

If your housing did not come with a flash deflector, use the included hook and loop material to block the flash. The included universal deflector material is white loop on one side and black on the other. Set it on your housing with the black side facing out. Trim to a size which blocks the most camera flash possible. Use the hook material to attach to the front of your housing.

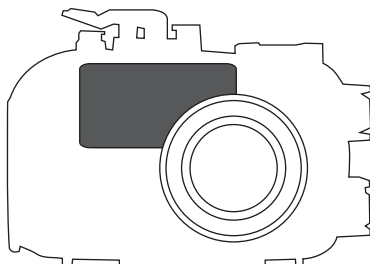
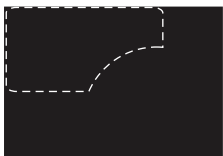
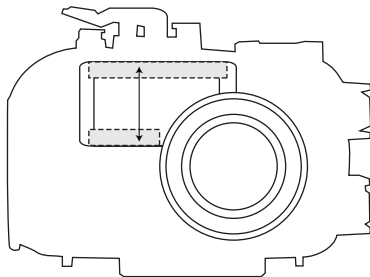

Assembling the Strobe

- Make sure the strobe is dry and the Power Switch is in the OFF position.
- Remove the Battery Door by loosening the knob on the back of the strobe. Note that the knob is not to be removed from the door.
- The o-ring should remain in the groove on the battery door. Check that the o-ring is in place and free of dirt or debris. This o-ring does not require lubrication as long as it is clean.
- Install 4 AA-cell alkaline, Li-Ion, NiCad, or NiMH batteries. The batteries must be installed in the correct direction. Refer to the + and - markings inside of the battery compartment for proper orientation.
- Replace the battery door by aligning the notch with the notch in the body. The o-ring will be visible through the battery door. Hand tighten until the o-ring forms goes from light gray in appearance to a solid, black line all of the way around. Do not overtighten.

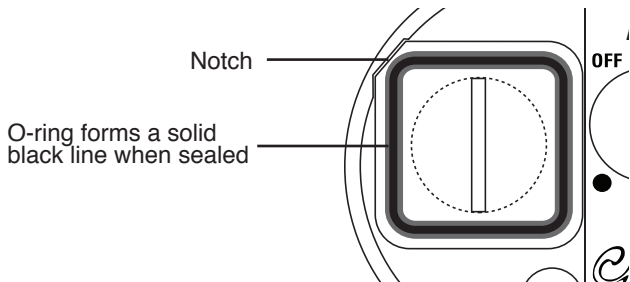

- To turn on, rotate the Power Switch to AUTO or a manual exposure setting. The strobe is ready to fire when the ready light glows red.

Configuring the AutoFlash Sensor

The Auto Exposure Selector Dial is used to fine tune the perfect TTL exposure for your photos. The Auto Exposure Selector Dial setting only affects the strobe's intensity when the AF35 is set to AUTO.

Start out with the Auto Exposure Selector Dial set to 5. Test your exposure from approximately 3 feet (1 m) away from a colorful, non-reflective subject. Attain focus on the subject and take a picture.

If the picture is over exposed (too light), move the dial to the next lower number.

If the picture is under exposed (too dark), move the dial to the next higher number.

Repeat until you are satisfied with the exposure.

Make note of this setting and use it each time you start out with your AF35 system. Change the setting if you switch to a different camera, or in situations where you want slightly more or less strobe power.

When using two strobes, we recommend starting with both strobes at the same sensor setting.

Auto Exposure
Selector Dial

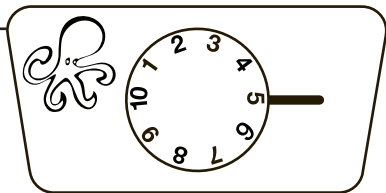

Manual Flash Exposure

In certain situations, the camera's sensor may not understand the subject well enough to choose the correct flash output automatically. This is especially common when shooting extreme close up photography, when shooting reflective surfaces, or when shooting subjects on very light colored backgrounds like sand. In these instances, manual flash exposure—where you set the output of the strobe flash—is desirable.

To switch to Manual Flash Exposure, simply rotate the AF35 strobe's Power Switch clockwise to one of the 6 manual exposure settings.

The first manual exposure setting is “F” which will provide a full power flash. Each setting thereafter represents a half-stop less power.

The -1 setting is equivalent to half of the power of the strobe.

The -2 setting is equivalent to one quarter of the power of the strobe.

Using the Diffuser

Adding a diffuser to the front of your strobe results in a softer, wider beam. A diffuser is especially useful when shooting wide angle photography.

We recommend using the two holes in the front of the diffuser to attach a string or lanyard between the diffuser and your strobe arm. This allows you to take the diffuser on and off underwater without dropping it and prevents accidental loss.

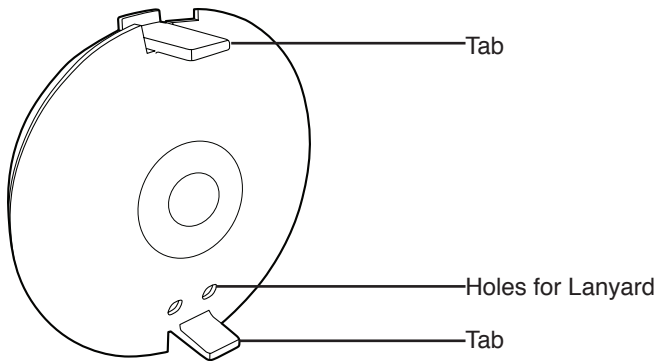

To attach the diffuser, insert it into the front of the strobe and align the tabs with the slots in the strobe front. Squeeze the tabs together towards the center to secure it.

To remove the diffuser, simply spread the tabs apart and separate from the strobe front.

Positioning the Strobe

The built-in Flex Arm allows the AF35 strobe to be placed in many different positions for optimum lighting. Position your strobe(s) farther away from the camera's lens and at a more straight forward angle for wide angle photography. Position your strobe(s) closer to the center of the housing and at a more acute angle for macro (close-up) photography.

The Flex Arm also protects the cord between your AF35 and the AutoFlash Sensor. If the Flex Arm separates for some reason, re-align the arm components and push them together to re-connect. Unlike with fiber optic cords, this built-in cord never requires polishing, maintenance, or replacement.

Maintenance

Your AF35 kit appreciates the same care and attention you give to your other photographic equipment. Follow these simple guidelines and you will enjoy years of regular use:

- Always make sure the battery compartment door is tightened properly before exposing the strobe to water.
- Rinse your housing and strobe(s) in fresh water and dry after each use. Store in a cool place out of direct sunlight.
- Never leave your camera system in a rinse tank or camera tank. Most accidental equipment damage occurs in the rinse tank.
- Remove batteries and leave the battery door only half-tightened when storing the strobe for extended periods of time.
- Always use fresh batteries and check the battery compartment for dirt or debris prior to assembly.
- Never re-use batteries which have been exposed to water.

Troubleshooting

| | |
|---|--|
| <p>Strobe will not fire.</p> | <ul style="list-style-type: none">• Replace batteries. Note that it is possible for brand new batteries to be dead.• Check that the batteries are installed correctly.• Turn the strobe to AUTO or a manual exposure setting.• Make sure the camera's built-in flash is set to fire on every shot. |
| <p>Photos are under-exposed (too dark).</p> | <ul style="list-style-type: none">• If strobe is set to AUTO, set the Exposure Adjustment Select Dial to a higher number.• If the strobe is in a manual power setting, rotate the Power Dial counter-clockwise towards the "F" Full position.• Adjust your camera settings.• Move closer to the subject. Optimal distance is approximately 3 feet (1 m) or less.• Position your strobe(s) closer to your subject.• Point your strobe(s) directly at the subject. |

Photos are over-exposed (too light).

- If strobe is set to AUTO, set the Exposure Adjustment Select Dial to a lower number.
- If the strobe is in a manual power setting, rotate the Power Dial clockwise away from the “F” Full position.
- Adjust your camera settings.
- Move away from the subject.
- Position your strobe(s) farther away from the subject.

Water enters the battery compartment.

- Remove the batteries and dispose of properly.
- Rinse the compartment with alcohol or fresh water.
- Blow the compartment completely dry with a hair drier or air from a scuba tank.
- Install new batteries. Never re-use water damaged batteries.
- Return the strobe to Ikelite for service.

Photo Tips

- Move in close to your subject to photograph through as little water as possible. No underwater flash is usable beyond about 6 feet (2 m). Recommended distance from subject is 3 feet (1 m) or less.
- Make sure your strobe is pointing towards the center of your frame if using one strobe, or slightly to one side of the center if using two strobes. Your strobe position(s) may need to be readjusted in between shots.
- Don't chase your subject—watch its behavior, position yourself appropriately, and wait for it to come to you.
- Half-depress the shutter button until the camera achieves focus, then push the rest of the way to take a photo.
- If possible, position yourself slightly below your subject and shoot at an upward angle for more depth to your photos.
- Use a wide angle lens to get closer to large subjects.
- Take your time and take several photos of each subject, and vary your angle and/or camera settings slightly between photos. The professionals come back each day with hundreds of photos to sort through!
- Don't trust your camera's LCD. Never delete a photo until you see it on a computer screen.
- Try to keep the sun behind you when shooting portraits.
- Avoid using a flash in extremely silty or low-visibility conditions.

Service and Repairs

Ikelite is most interested in performing any service to ensure that all products perform as intended. Evidence of purchase date must be provided to obtain warranty service.

No prior authorization is required. You may return directly to us or through your dealer. Please include a brief description of the problem, any relevant email correspondence, and/or instructions on what you want us to do. Always include name, shipping address, email address, and phone number inside of the package. Send postage paid to:

Ikelite Service Dept.
50 West 33 Street
Indianapolis, IN 46208 USA

No reimbursements for postage paid will be issued. You may also want to insure the package.

For the separate international customs documentation form that you complete to accompany the shipment, please state or designate that the enclosed products were originally manufactured in the USA and are being returned to the manufacturer for repair service. Value of the equipment listed for customs purposes should be zero.

Limited Warranty

This product is warranted against manufacturing defects for a period of one year from the date of purchase. Defective products should be returned prepaid to Ikelite. Ikelite will, at its discretion, (a) repair utilizing new, remanufactured, and/or recycled parts; (b) exchange for a new product or; (c) exchange for a refurbished product; and return to customer prepaid. All other claims, of any nature, are not covered. Except as mentioned above, no other warranty, express or implied, applies to this product.

Contact Us

Ikelite Underwater Systems
50 W 33rd St
Indianapolis, IN 46208 USA
(317) 923-4523
ikelite.com